

Permanent alnico horse shoe magnet type AA 04

REF 83.04
{ERREUR : balise [PRESTATION_CRITERE_ASoust] inconnue}

Mounting, Assembly, Lock, Clamping

Aluminum Nickel Cobalt magnets are castings that offer a good mechanical resistance as well as an elevated induction in closed circuit.

The strength is highest when the magnet is in contact with a Mild Steel, that is clean and thick enough. The Strength is reduced when in contact with Alloy steels (cast Iron -30%), due to air-gap or a high temperature (-0.02% per degree °C). **ALNICO magnets are Machinable, they can be cut on request. The mounting is done with glue.** Horse shoe magnet with a north pole side and a south pole side.

Options

Reference	Poids en kg	A	B	C	D	E
83.04-20	0.022	20	17.4	4.2	6	10N
83.04-24.5	0.030	24.5	24.5	64	7	20N
83.04-28.5	0.038	28.5	24.9	7.9	7.9	30N

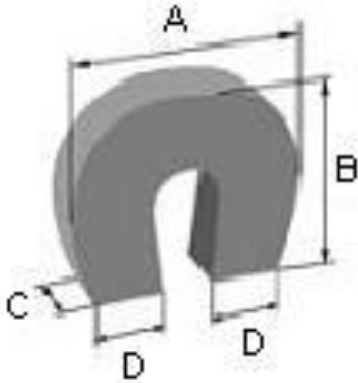

E= Force - Force - Kraft